

# West Burton Solar Project

## Streets Plan Revision C

Prepared by: Lanpro Services  
February 2024

PINS reference: EN010132  
Document reference: EX4/WB2.11\_C  
APFP Regulation 5(2)(k)



## Schedule of Changes

Figure Reference	Page	Description of Changes	Reason for Revision
All sheets	3-13	Updates to annotations and title block	For presentational clarity.
Index Sheet	3	Changes to Order limits and relevant annotations	Change Application
Sheet 1 of 10	4	Extension of Order Limits, and point 1a moved accordingly	Presentation of Order Limit Change 1
Sheet 5 of 10	8	Extension of Order Limits	Presentation of Order Limit Change 2
Sheet 6 of 10	9	Extension of Order Limits, and point 6h moved accordingly	Presentation of Order Limit Change 3
Sheet 7 of 10	10	Extension of Order Limits, and point 7g moved accordingly	Presentation of Order Limit Change 4
Sheet 10 of 10	13	Extension of Order Limits, and private access 10k-10p added	Presentation of Order Limit Change 5



- Key**
- Order Limits
  - Sheet Index
  - Reference point within schedule
  - Street to be temporarily stopped up
  - Street works / Street subject to traffic regulation measures
  - Private access to be temporarily stopped up
  - Private access works / Private access subject to traffic regulation measures

Layers: Historic England, 2024; Nottinghamshire County Council, 2024; Lincolnshire County Council, 2024; Lanpro, 2024; IGP, 2024  
 Base map: Reproduced from Ordnance Survey digital map data © Crown copyright 2024. All rights reserved. License number 0100031673

0 1 2 Kilometres  
 Scale: 1:17,500@A0

APPP Regulation: 5(2)(k)	Application Doc No. EX4/WB2.11_C
Ref: P2983_LPR_ZZ_ON_DR_Z_0211	Date: 28/02/2024
Drawn by: AZ	Checked by: JC

**Streets Plan**  
 Index Sheet  
 Revision C

**WEST BURTON SOLAR PROJECT**

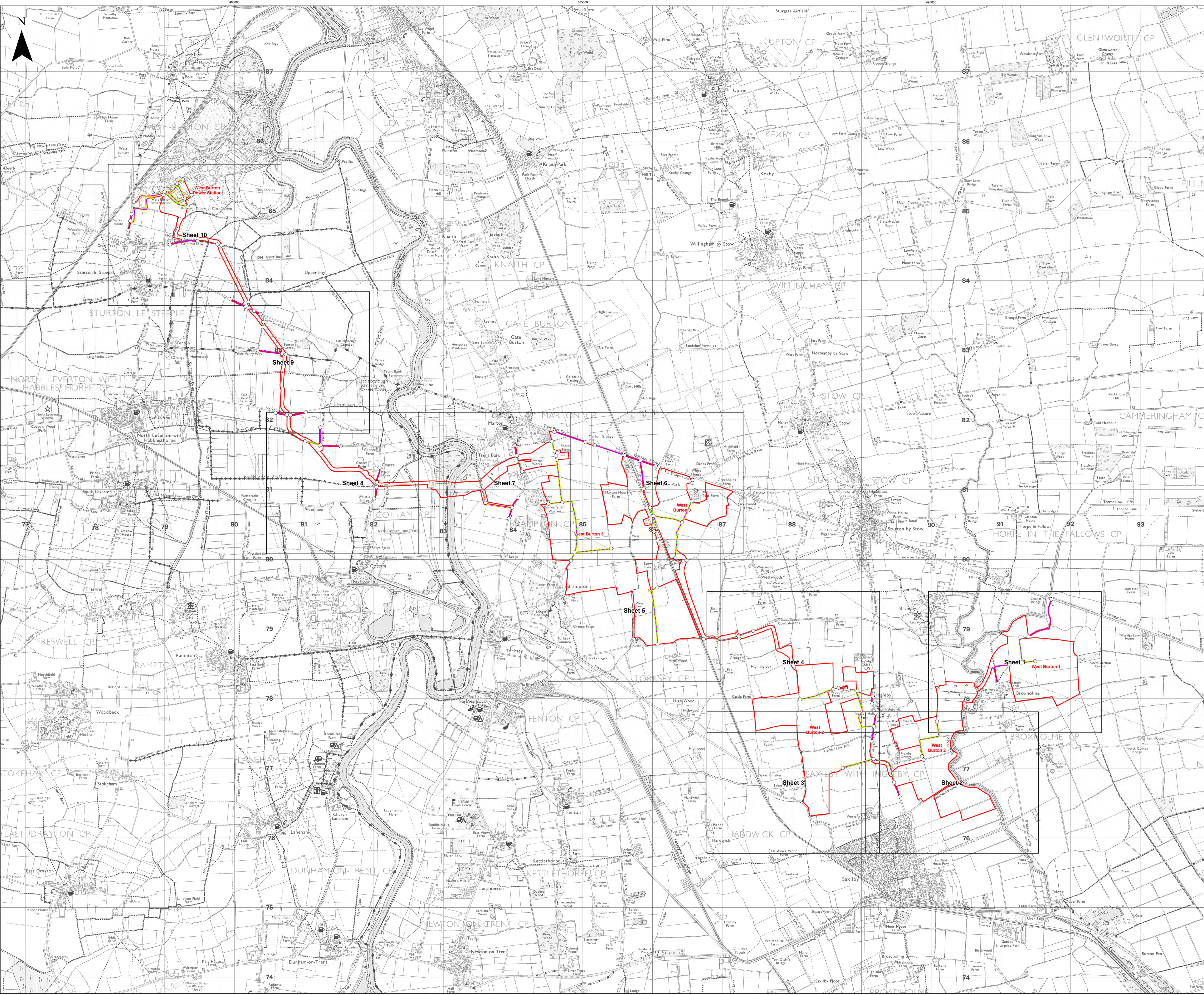



- Key**
- Order Limits
  - Sheet Index
  - Reference point within schedule
  - Street to be temporarily stopped up
  - Street works / Street subject to traffic regulation measures
  - Private access to be temporarily stopped up
  - Private access works / Private access subject to traffic regulation measures

Layers: Lincolnshire County Council, 2024; Nottinghamshire County Council, 2024; North Lincolnshire County Council, 2024; Lanpro, 2024; IGP, 2024  
Base map: Reproduced from Ordnance Survey digital map data © Crown copyright 2024. All rights reserved. License number 0100031673

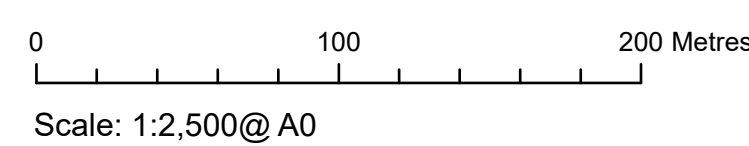

APFP Regulation: 5(2)(k)	Application Doc No. EX4/WB2.11_C
Ref: P2963_LPR_ZZ_ON_DR_Z_0212	Date: 28/02/2024
Drawn by: AZ	Checked by: JC

**Streets Plan**  
Sheet 1 of 10  
Revision C

**WEST BURTON SOLAR PROJECT**

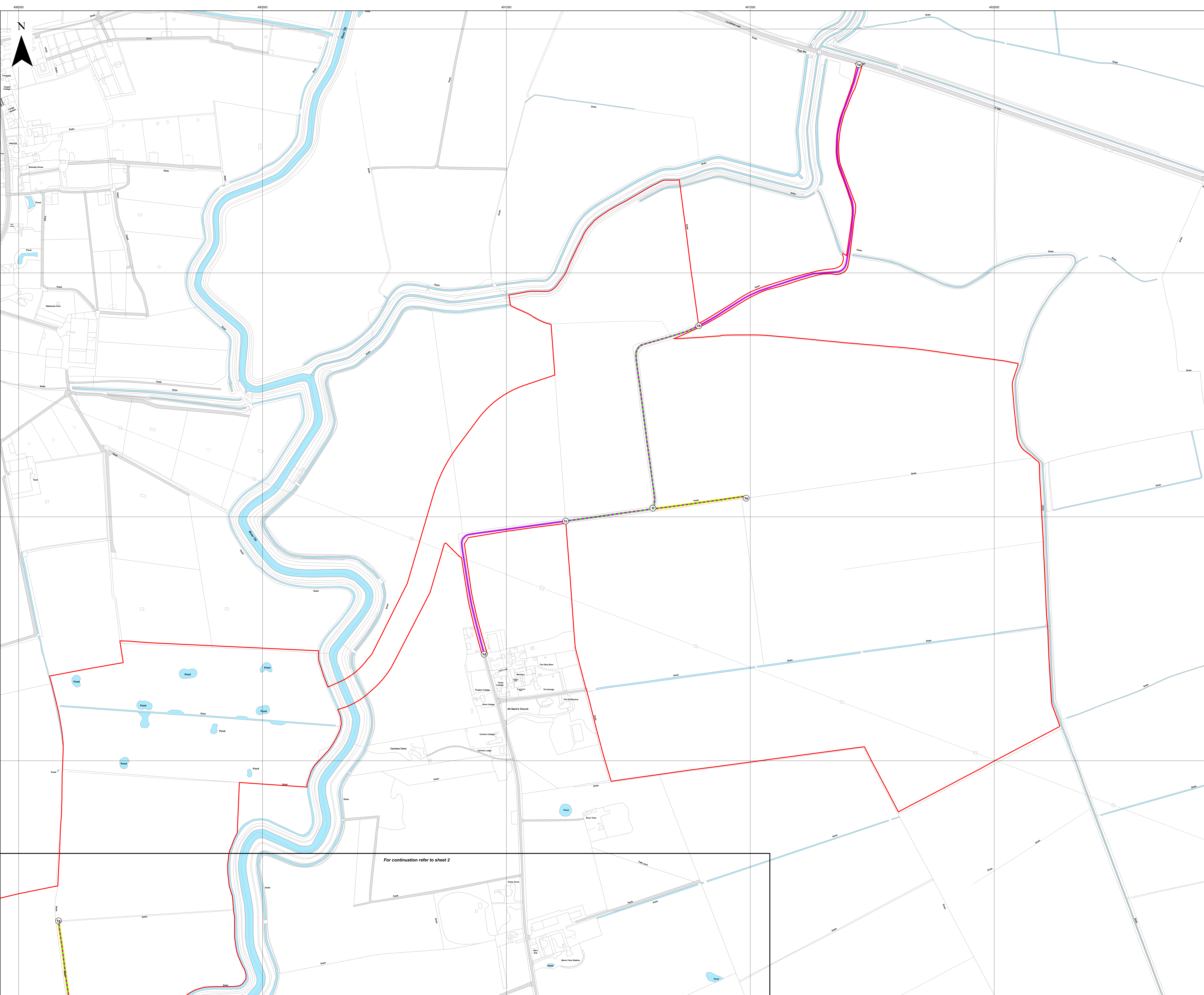



- Key**
- Order Limits
  - Sheet Index
  - Reference point within schedule
  - Street to be temporarily stopped up
  - Street works / Street subject to traffic regulation measures
  - Private access to be temporarily stopped up
  - Private access works / Private access subject to traffic regulation measures

For continuation refer to sheet 1

For continuation refer to sheet 3

Layers: Lincolnshire County Council, 2024; Nottinghamshire County Council, 2024; North Lincolnshire County Council, 2024; Lanpro, 2024; IGP, 2024  
Base map: Reproduced from Ordnance Survey digital map data © Crown copyright 2024. All rights reserved. License number 0100031673

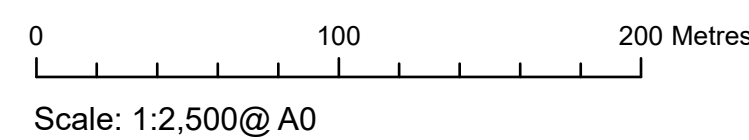

APFP Regulation: 5(2)(k)	Application Doc No. EX4/WB2.11_C
Ref: P2963_LPR_ZZ_ON_DR_Z_0212	Date: 28/02/2024
Drawn by: AZ	Checked by: JC

**Streets Plan**  
Sheet 2 of 10  
Revision C

**WEST BURTON SOLAR PROJECT**



- Key**
- Order Limits
  - Sheet Index
  - Reference point within schedule
  - Street to be temporarily stopped up
  - Street works / Street subject to traffic regulation measures
  - Private access to be temporarily stopped up
  - Private access works / Private access subject to traffic regulation measures

Layers: Lincolnshire County Council, 2024; Nottinghamshire County Council, 2024; North Lincolnshire County Council, 2024; Lanpro, 2024; IGP, 2024  
Base map: Reproduced from Ordnance Survey digital map data © Crown copyright 2024. All rights reserved. License number 0100031673

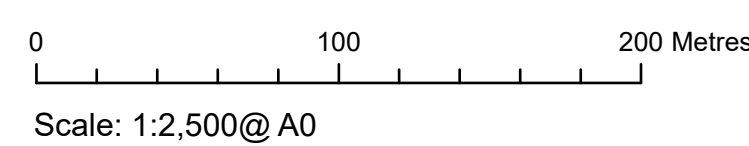

APFP Regulation: 5(2)(k)	Application Doc No. EX4/WB2.11_C
Ref: P2963_LPR_ZZ_ON_DR_Z_0212	Date: 28/02/2024
Drawn by: AZ	Checked by: JC

**Streets Plan**  
Sheet 3 of 10  
Revision C

**WEST BURTON SOLAR PROJECT**

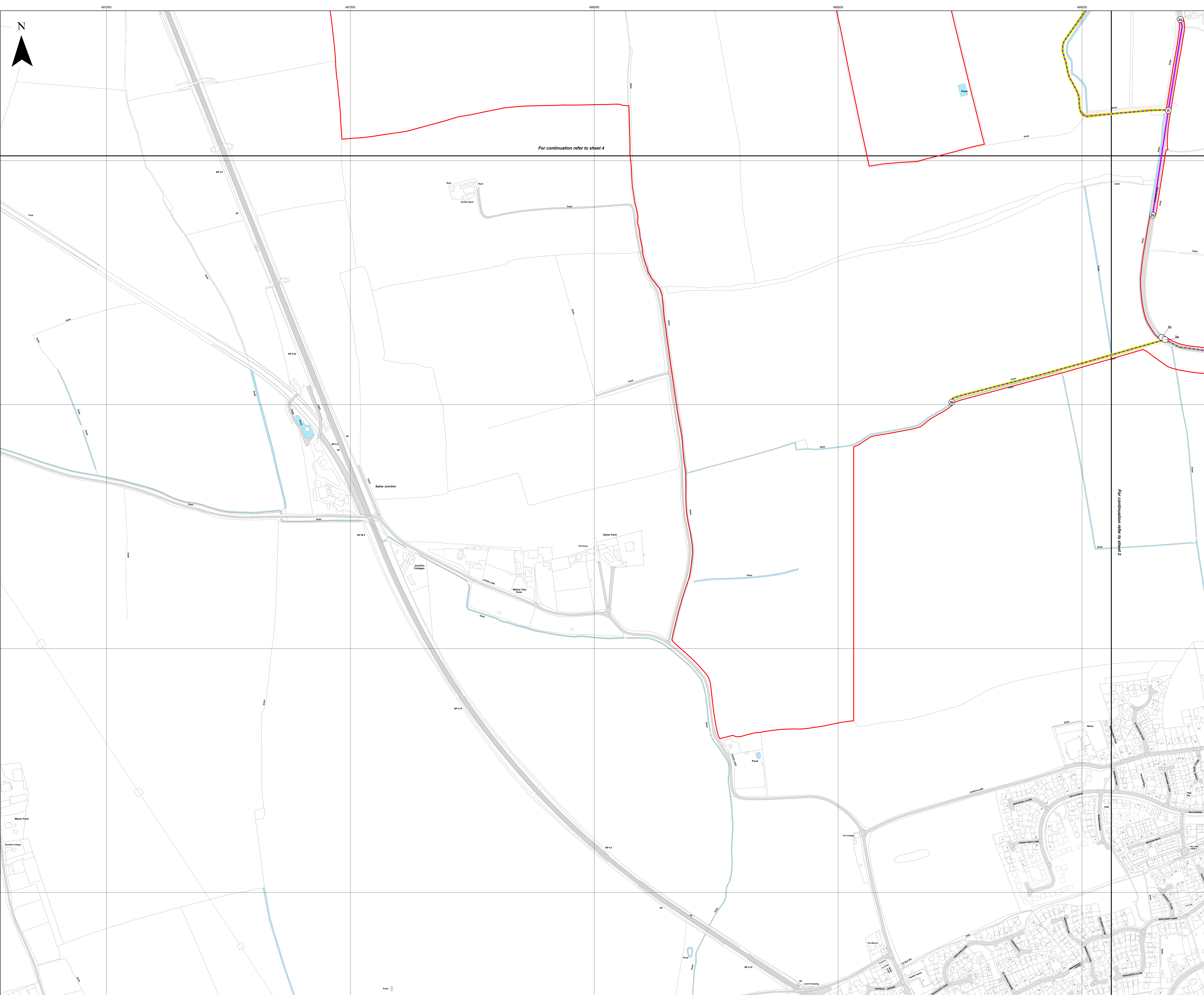

For continuation refer to sheet 4

For continuation refer to sheet 2



**Key**

- Order Limits
- Sheet Index
- Reference point within schedule
- Street to be temporarily stopped up
- Street works / Street subject to traffic regulation measures
- Private access to be temporarily stopped up
- Private access works / Private access subject to traffic regulation measures

Layers: Lincolnshire County Council, 2024; Nottinghamshire County Council, 2024; North Lincolnshire County Council, 2024; Lanpro, 2024; IGP, 2024  
Base map: Reproduced from Ordnance Survey digital map data © Crown copyright 2024. All rights reserved. License number 0100031673

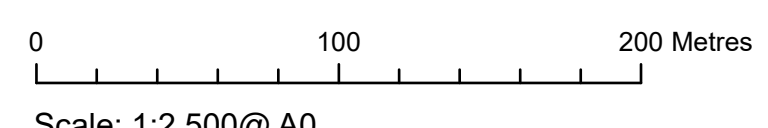

APFP Regulation: 5(2)(k)	Application Doc No. EX4/WB2.11_C
Ref: P2963_LPR_ZZ_ON_DR_Z_0212	Date: 28/02/2024
Drawn by: AZ	Checked by: JC

**Streets Plan**  
Sheet 4 of 10  
Revision C

**WEST BURTON SOLAR PROJECT**

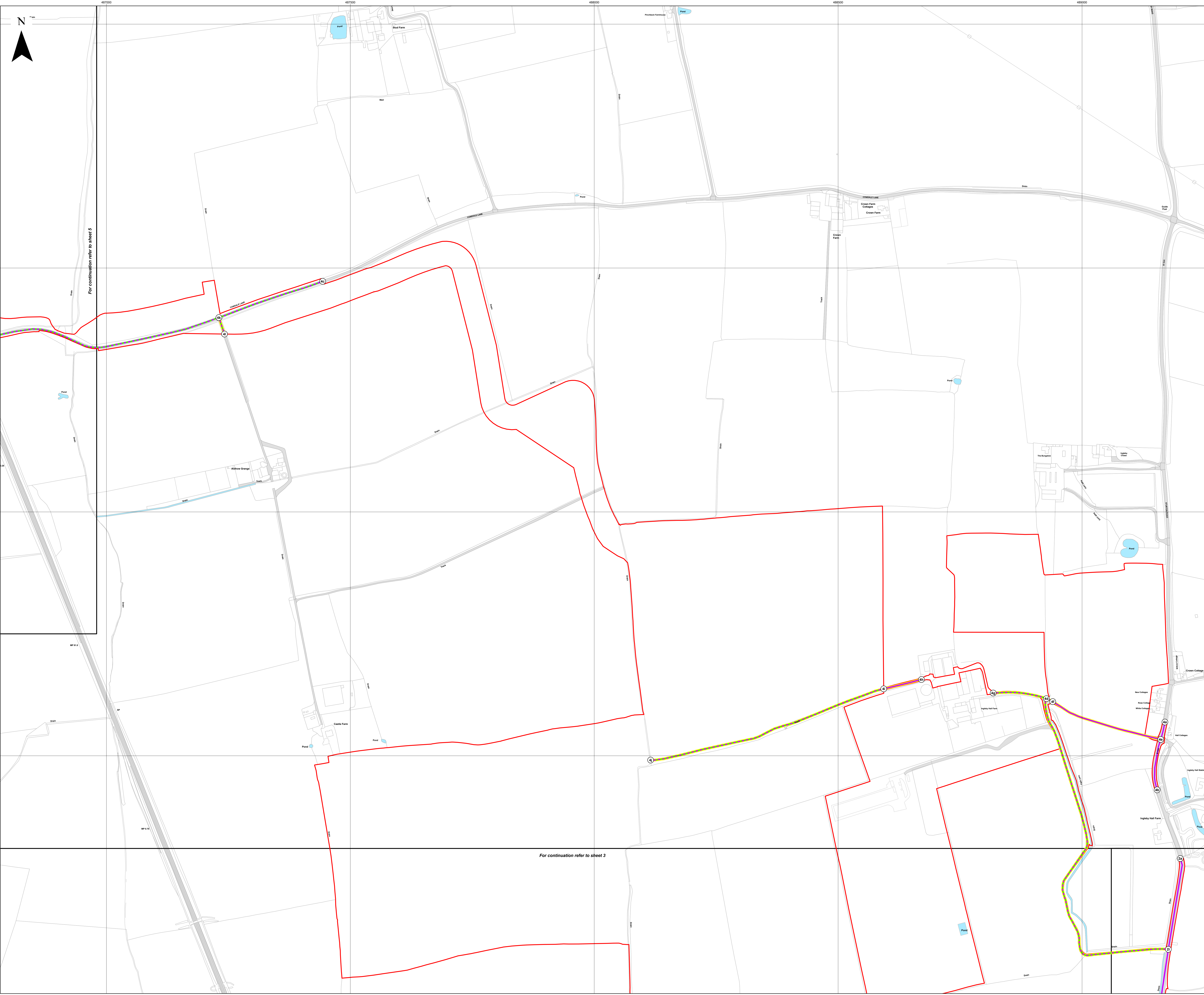

For continuation refer to sheet 5

For continuation refer to sheet 3



- Key**
- Order Limits
  - Sheet Index
  - Reference point within schedule
  - Street to be temporarily stopped up
  - Private access to be temporarily stopped up
  - Private access works / Private access subject to traffic regulation measures

Layers: Lincolnshire County Council, 2024; Nottinghamshire County Council, 2024; North Lincolnshire County Council, 2024; Lanpro, 2024; IGP, 2024  
Base map: Reproduced from Ordnance Survey digital map data © Crown copyright 2024. All rights reserved. License number 0100031673

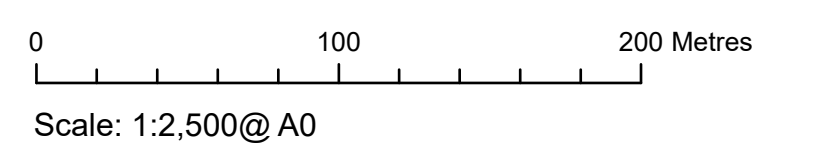

Scale: 1:2,500@ A0

APFP Regulation: 5(2)(k)	Application Doc No. EX4/WB2.11_C
Ref: P2963_LPR_ZZ_ON_DR_Z_0212	Date: 28/02/2024
Drawn by: AZ	Checked by: JC

**Streets Plan**  
Sheet 5 of 10  
Revision C

**WEST BURTON SOLAR PROJECT**

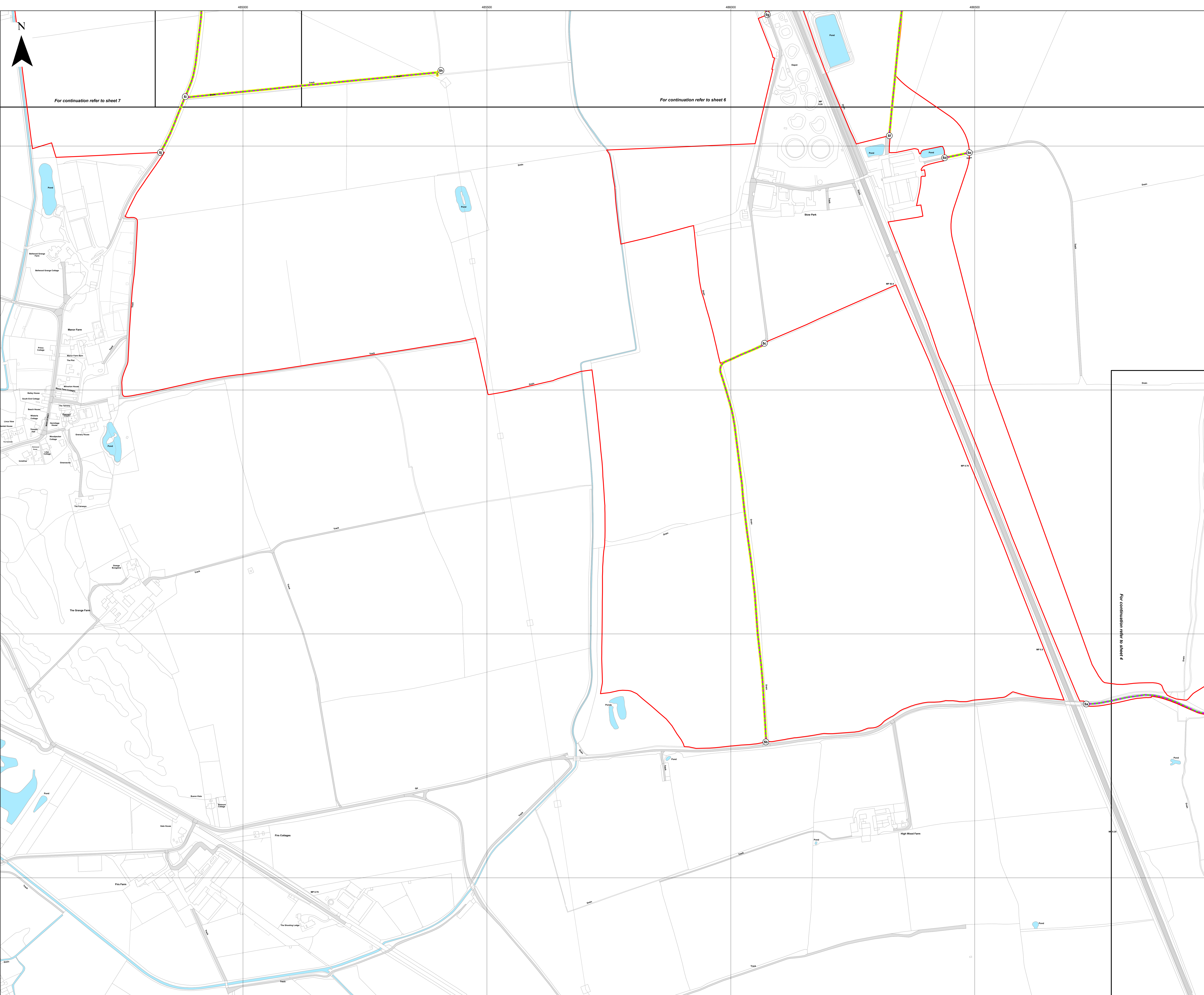



- Key**
- Order Limits
  - Sheet Index
  - Reference point within schedule
  - Street works / Street subject to traffic regulation measures
  - Private access to be temporarily stopped up
  - Private access works / Private access subject to traffic regulation measures

Layers: Lincolnshire County Council, 2024; Nottinghamshire County Council, 2024; North Lincolnshire County Council, 2024; Lanpro, 2024; IGP, 2024  
Base map: Reproduced from Ordnance Survey digital map data © Crown copyright 2024. All rights reserved. License number 0100031673

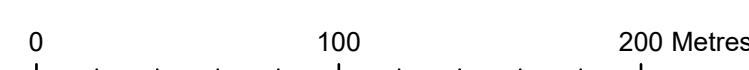

Scale: 1:2,500@ A0





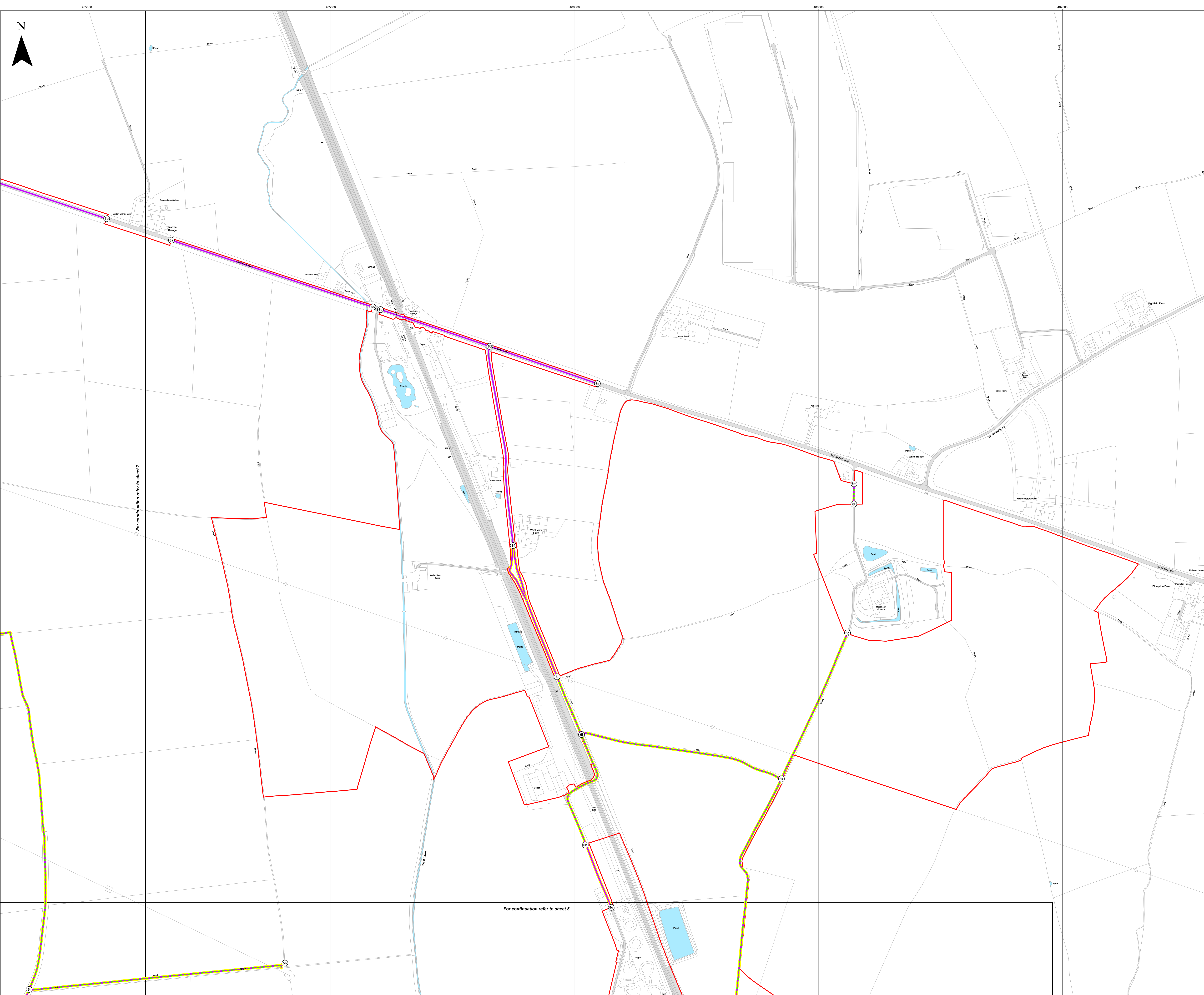

APFP Regulation: 5(2)(k)	Application Doc No. EX4/WB2.11_C
Ref: P2963_LPR_ZZ_ON_DR_Z_0212	Date: 28/02/2024
Drawn by: AZ	Checked by: JC

**Streets Plan**  
Sheet 6 of 10  
Revision C

**WEST BURTON SOLAR PROJECT**





- Key**
-  Order Limits
  -  Sheet Index
  -  Reference point within schedule
  -  Street to be temporarily stopped up
  -  Street works / Street subject to traffic regulation measures
  -  Private access to be temporarily stopped up
  -  Private access works / Private access subject to traffic regulation measures

Layers: Lincolnshire County Council, 2024; Nottinghamshire County Council, 2024; North Lincolnshire County Council, 2024; Lanpro, 2024; IGP, 2024  
 Base map: Reproduced from Ordnance Survey digital map data © Crown copyright 2024. All rights reserved. License number 0100031673

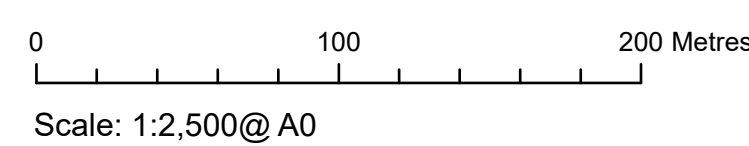

APFP Regulation: 5(2)(k)	Application Doc No. EX4/WB2.11_C
Ref: P2963_LPR_ZZ_ON_DR_Z_0212	Date: 28/02/2024
Drawn by: AZ	Checked by: JC

**Streets Plan**  
 Sheet 7 of 10  
 Revision C

**WEST BURTON SOLAR PROJECT**

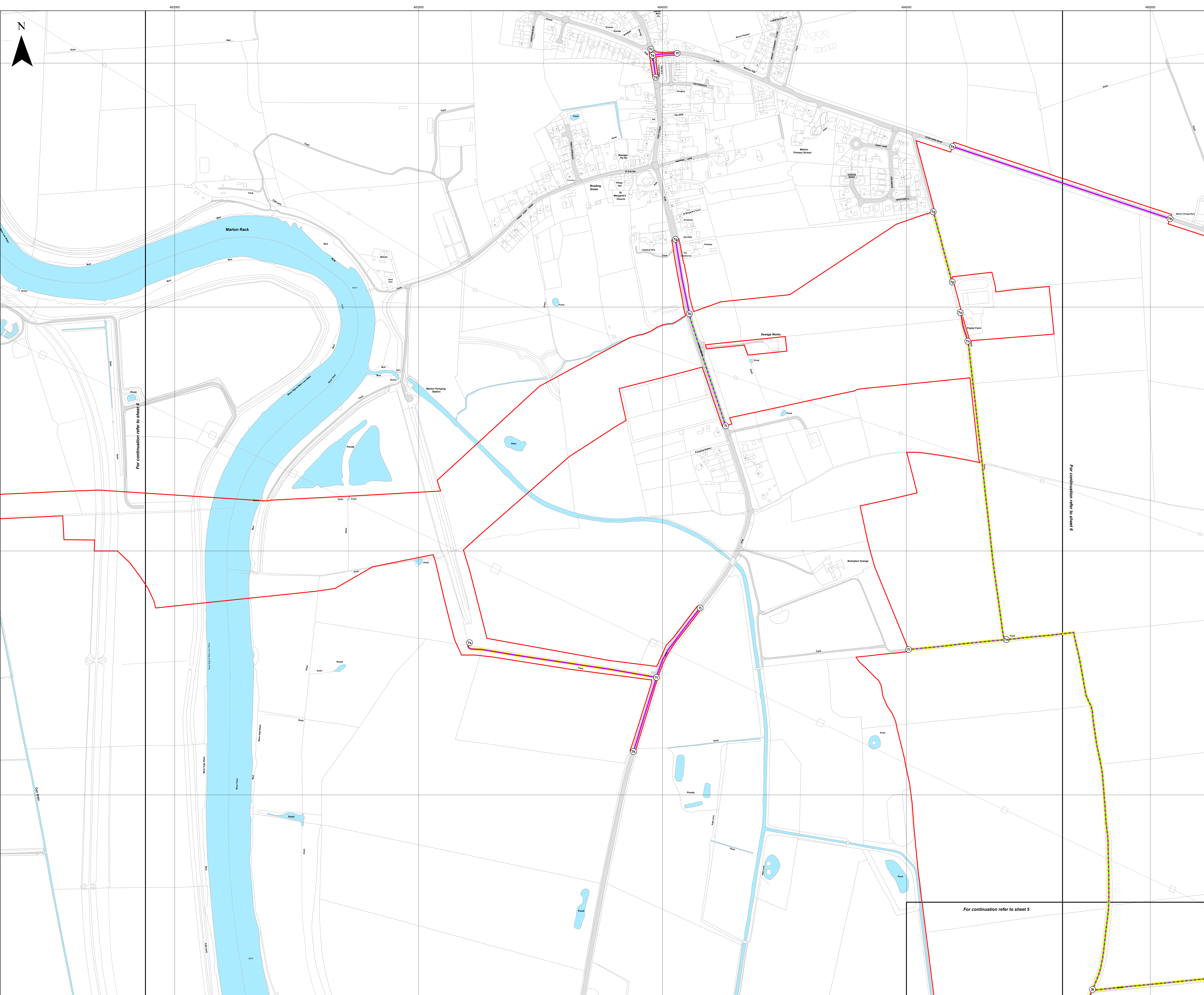



**Key**

- Order Limits
- Sheet Index
- Reference point within schedule
- Street to be temporarily stopped up
- Street works / Street subject to traffic regulation measures
- Private access to be temporarily stopped up
- Private access works / Private access subject to traffic regulation measures

Layers: Lincolnshire County Council, 2024; Nottinghamshire County Council, 2024; North Lincolnshire County Council, 2024; Lanpro, 2024; IGP, 2024  
Base map: Reproduced from Ordnance Survey digital map data © Crown copyright 2024. All rights reserved. License number 0100031673

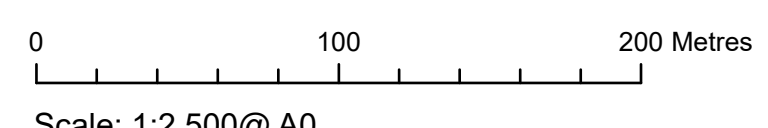

APFP Regulation: 5(2)(k)	Application Doc No. EX4/WB2.11_C
Ref: P2963_LPR_ZZ_ON_DR_Z_0212	Date: 28/02/2024
Drawn by: AZ	Checked by: JC

**Streets Plan**  
Sheet 8 of 10  
Revision C

**WEST BURTON SOLAR PROJECT**

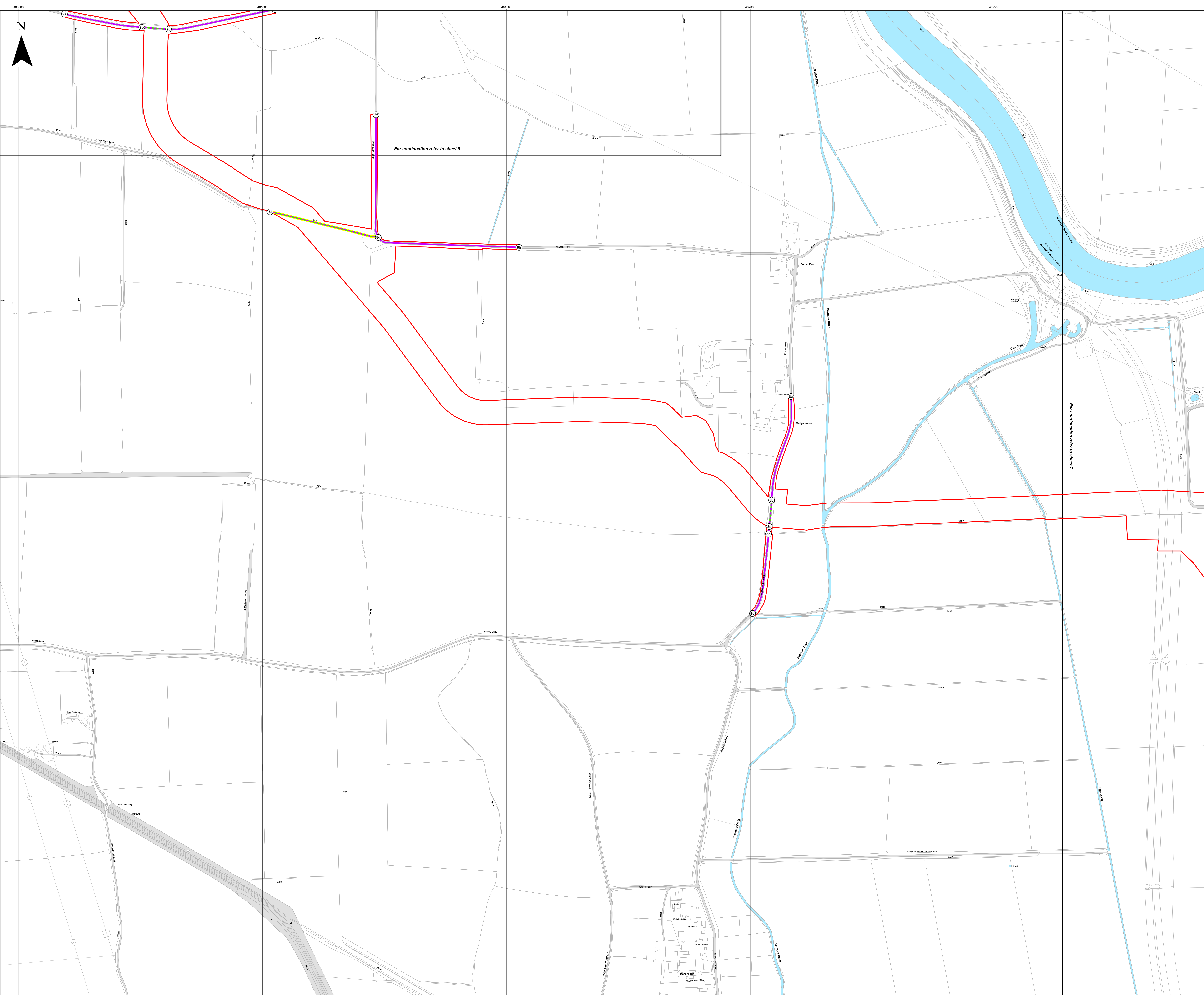



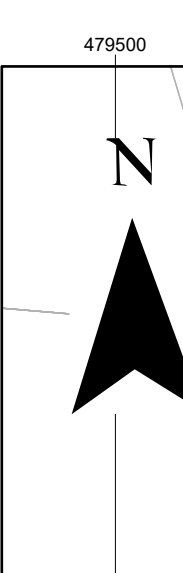
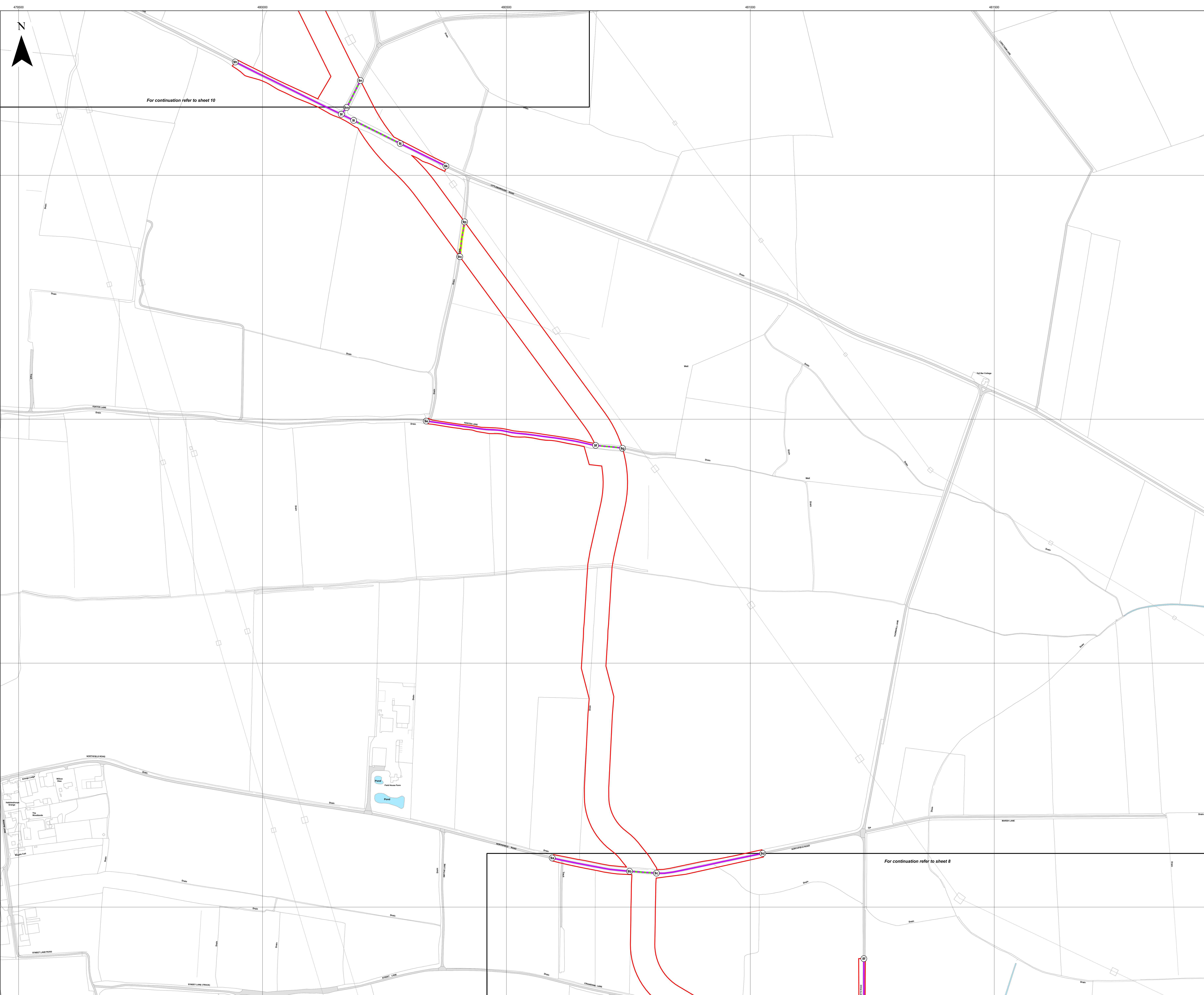

479000  
480000  
481000

392000  
393000  
394000  
395000

For continuation refer to sheet 10

For continuation refer to sheet 8



- Key**
- Order Limits
  - Sheet Index
  - Reference point within schedule
  - Street to be temporarily stopped up
  - Street works / Street subject to traffic regulation measures
  - Private access to be temporarily stopped up
  - Private access works / Private access subject to traffic regulation measures

Layers: Lincolnshire County Council, 2024; Nottinghamshire County Council, 2024; North Lincolnshire County Council, 2024; Lanpro, 2024; IGP, 2024  
Base map: Reproduced from Ordnance Survey digital map data © Crown copyright 2024. All rights reserved. License number 0100031673

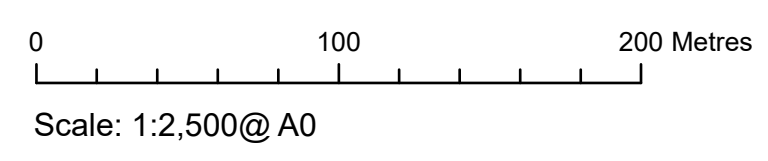

APFP Regulation: 5(2)(k)	Application Doc No. EX4/WB2.11_C
Ref: P2963_LPR_ZZ_ON_DR_Z_0212	Date: 28/02/2024
Drawn by: AZ	Checked by: JC

**Streets Plan**  
Sheet 9 of 10  
Revision C

**WEST BURTON SOLAR PROJECT**



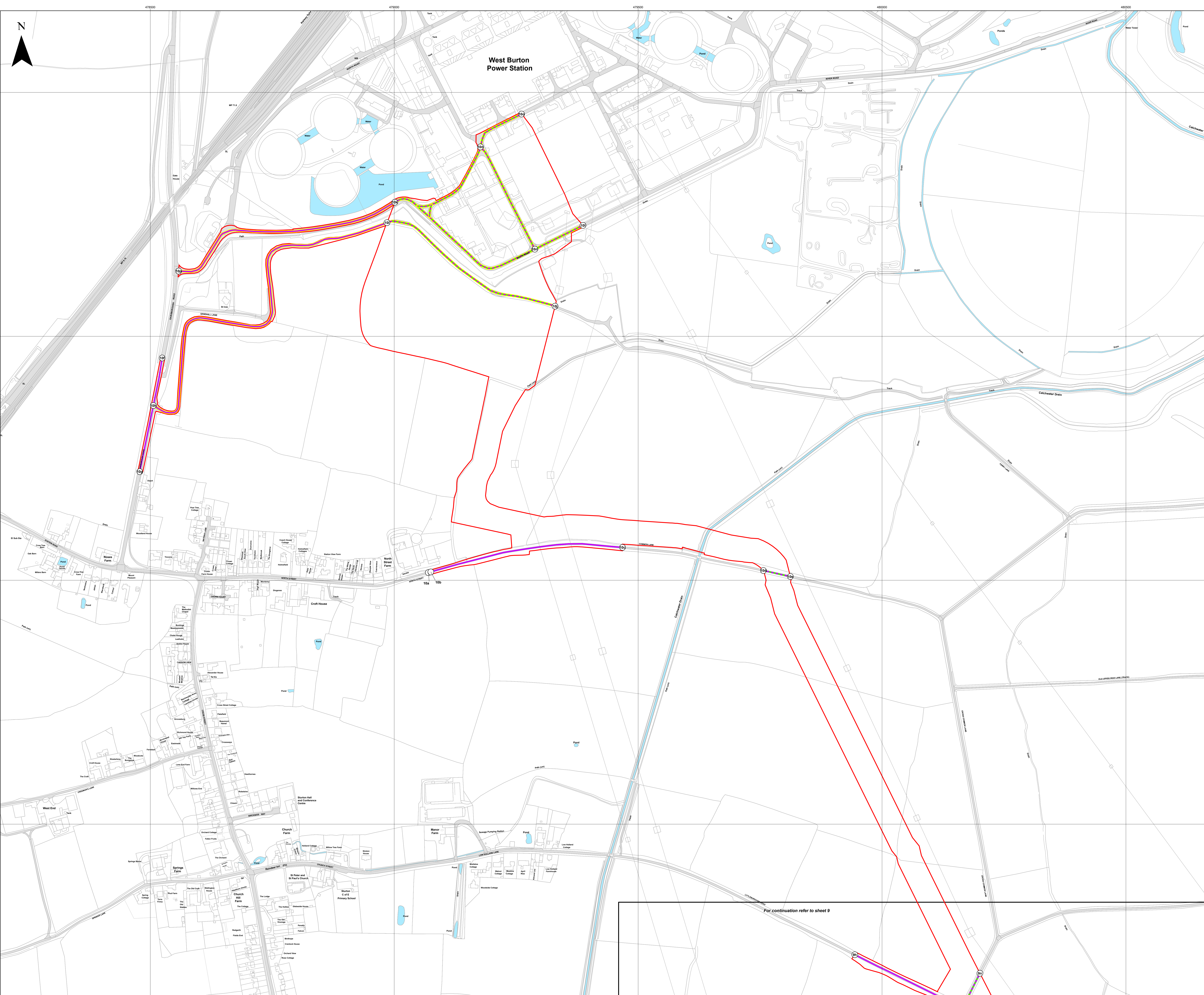

- Key**
- Order Limits
  - Sheet Index
  - Reference point within schedule
  - Street to be temporarily stopped up
  - Street works / Street subject to traffic regulation measures
  - Private access to be temporarily stopped up
  - Private access works / Private access subject to traffic regulation measures

Layers: Lincolnshire County Council, 2024; Nottinghamshire County Council, 2024; North Lincolnshire County Council, 2024; Lanpro, 2024; IGP, 2024  
 Base map: Reproduced from Ordnance Survey digital map data © Crown copyright 2024. All rights reserved. License number 0100031673

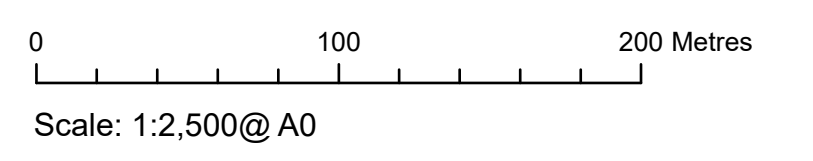

APFP Regulation: 5(2)(k)	Application Doc No. EX4/WB2.11_C
Ref: P2983_LPR_ZZ_ON_DR_Z_0212	Date: 28/02/2024
Drawn by: AZ	Checked by: JC

For continuation refer to sheet 9

**Streets Plan**  
 Sheet 10 of 10  
 Revision C

**WEST BURTON SOLAR PROJECT**